

For the best performance and prolonged tool life always use Rotabroach cutting fluid and lubricants.



Ralli Wolf

- The 'Commando 50' is one of Ralliwolf most versatile machines.
- Small in size, with reversible features to allow tapping.
- Suitable for drilling up to 50mm diameter by 50mm depth.
- The Commando 50 can be supplied as a non-tapping machine.
- The Commando use a dual motor protection system prolonging the machines life.

COMMANDO 50 Specifications

Model Number	Commando 50
Motor specification	110V 1500W / 230V 1500W
No Load RPM	Low Gear: 100 - 265 RPM / High Gear: 200 - 500 RPM
Max Hole Cutting Capacity	ø50 x 50mm Deep - 23mm with 2MT shank drill
Overall Dimensions	Height 460mm / Width 195mm with Capstan / Length 400mm with Guard
Machine Weight	15.8kg
Magnetic Adhesion	13,500N
Magnet Size	200mm x 98mm
Safety Features	Cutsmart™ Technology / Fixed Guard / Magnetic Detection / Mechanical Clutch/ Secondary motor protection

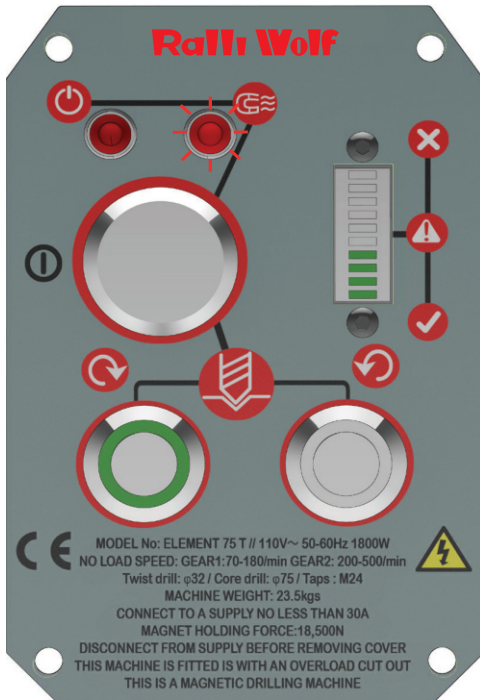

Red magnet LED - Indicates optimum adhesion not achieved. Drilling operation is still available but the red magnet LED makes the operator aware of a reduced magnetic strength.

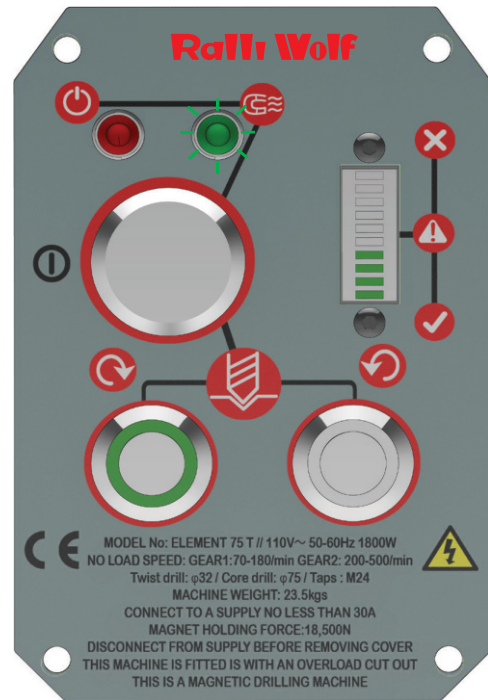

Green magnet LED - Drilling operation is available. This makes the operator aware of the optimum magnetic strength.

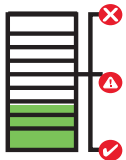

Green Zone
 Perfect, try to keep in the green zone for the best cut and optimum machine performance.

The Commando range is fitted with Ralliwolf unique CutSmart™ panels designed to increase your tool life and productivity.



Yellow Zone
 A little too much pressure on the drill, ease off to get back to the green zone.

Designed for you to get the most out of your machine and cutter. CutSmart™ has an easy to read panel that indicates when you are applying too much force avoiding inappropriate wear. Cutsmart™ allows the cutter to do the work and you will find that a much smoother hole and faster drilling time is achieved.



Red Zone
 Overload: Back off immediately as too much force will cause the motor to cut off if you continue.

Ralli Engineering Ltd.

An ISO 9001:2015 Certified Organisation

Regd. Office :

4, Fairlie Place Kolkata - 700001 (India)
 E : info@ralliwolf.com, P : +91 33 2262 7341
 CIN : U51109WB1996PLC077080

Sales Network :

Ahmedabad, Bangalore, Baroda, Bhopal, Chennai, Cuttack, Coimbatore, Delhi, Guwahati, Jaipur, Jamshedpur, Jharsuguda, Kolkata, Ludhiana, Mumbai, Nagpur, Pune, Rajkot, Secunderabad, Trichy, Vishakhapatnam